

DS-PK502 Series Bus Outdoor Keypad

Quick Start Guide

EN 50131-1:2006 + A1:2009 + A2:2017 + A3:2020
 EN 50131-3:2009
 EN 50131-5-3:2017
 EN 50131-6:2017+A1:2021

Security Grade 2
 Environmental Class II

User Manual Flow Chart

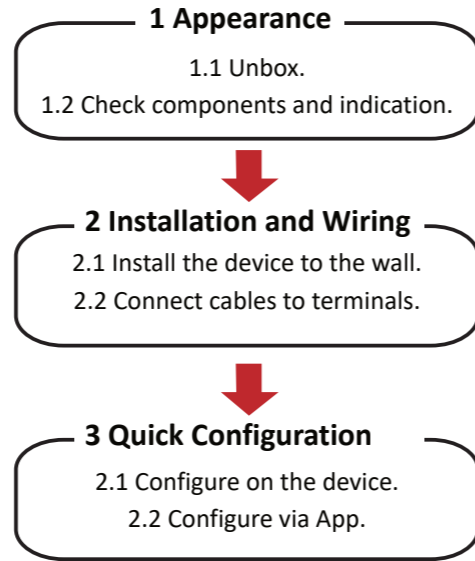

1 Packing List

| | | |
|--------|-------------------|--------|
| Keypad | Quick Start Guide | Screws |
| EoL | Jumper Cap | Tag |

1 Appearance and Indicator

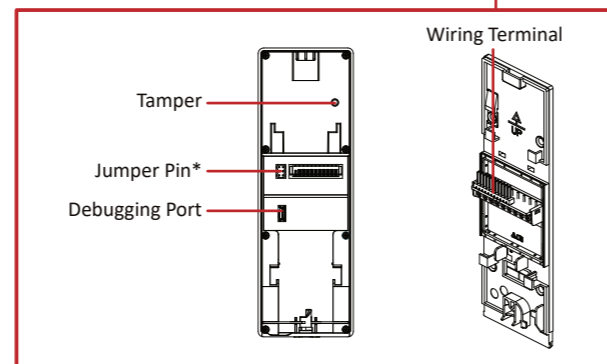
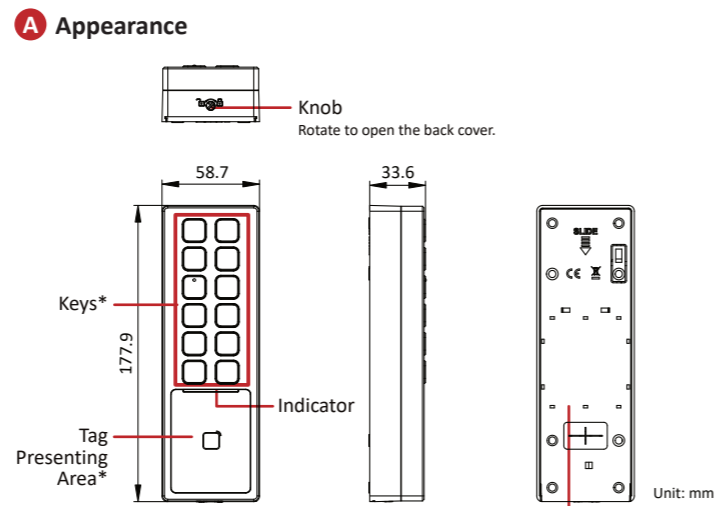

*Key: Press the key to arm/disarm, etc.
 *Tag Presenting Area: Parts of the device models supports tag presenting function.
 *Jumper Pin: Use the jumer cap to select NC/NO output type or 120Ω resistor.

B Key Descriptions

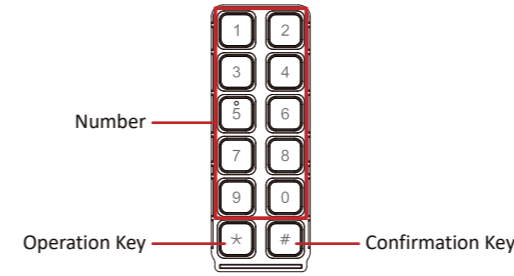

B Jumer Cap Descriptions

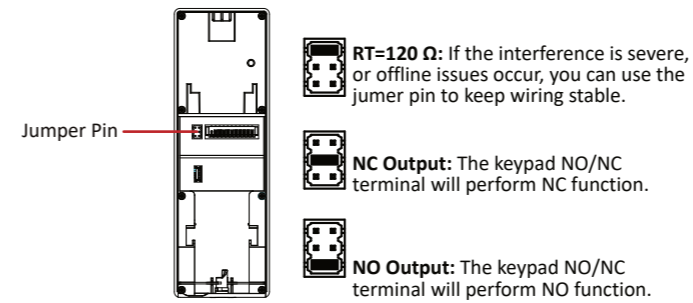

C Indicator Descriptions

| Indicator | Indicator Status | Device Status |
|-----------|------------------------------|---------------------------------------|
| — | Solid Red | Tampering |
| ⋯ | Red Light Flashes | Enrolling Failed |
| ⋯ | Red Light Flashes 5 s | In Alarm |
| ⋯ | Orange Light Flashes | Operation Failed |
| — | Solid Orange | Arming/Disarming Fault |
| ⋯ | Yellow Light Flashes | Waiting Duration after Presenting Tag |
| — | Solid Green | Locked |
| ⋯ | Yellow Light Flashes 60 s | Device Offline |
| — | Solid Green for 1 s | Waiting for Enrollment |
| ⋯ | Green Light Flashes | Disarming Status |
| ⋯ | Green Light Flashes 3.5 s | Power On |
| — | Solid Blue | Exiting Delay Zone |
| ⋯ | Green Light Flashes 5 s | Enrolled |
| — | Solid Blue | Disarmed |
| ⋯ | Blue Light Flashes | Operation Completed (Without Arming) |
| — | Solid Blue | Arming Status |
| ⋯ | Blue Light Flashes 5 s | Entering Delay Zone |
| ⋯ | Green and Blue Light Flashes | Find Me |
| ⋯ | Green and Blue Light Flashes | Armed |
| ⋯ | Green and Blue Light Flashes | In Installation Mode |

2 Installation and Wiring

Step 1. Use a flathead screwdriver to turn the knob at the bottom of the device to the unlock position.

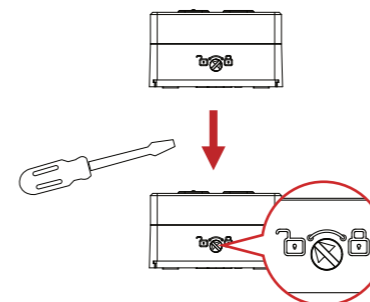

Step 2. Slide the back cover downward to separate it from the device.
 Note: Press the cable hole as a leverage point to slide downward more effectively.

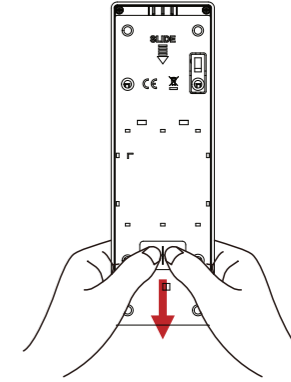

Step 3. Complete wiring.

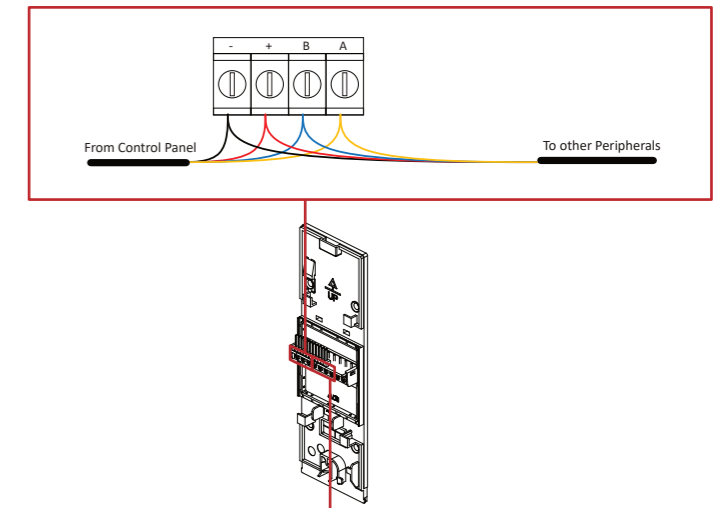

A When Detector Contact Mode is NC

1 Non Resistor Wiring

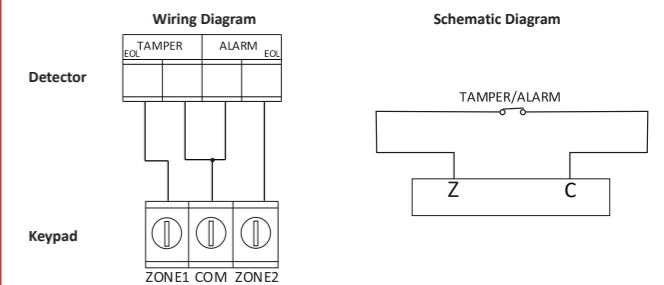

2 Single EOL Wiring

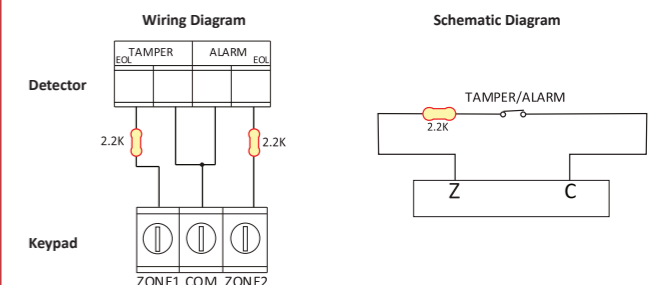

User Manual



More Languages



UD45099B-B

3 Double EOL Wiring

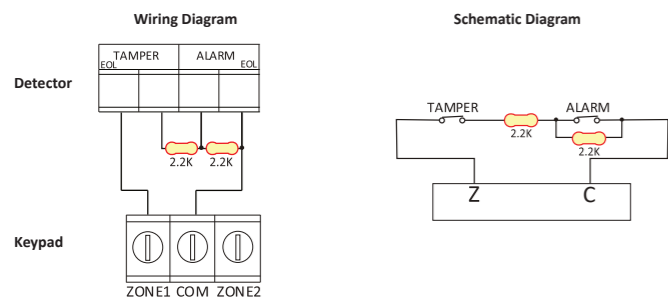

4 Triple EOL Wiring

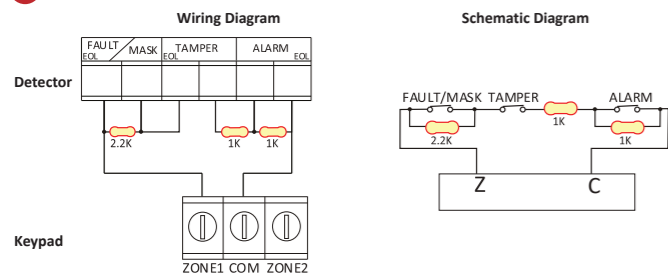

5 Double Zone Wiring

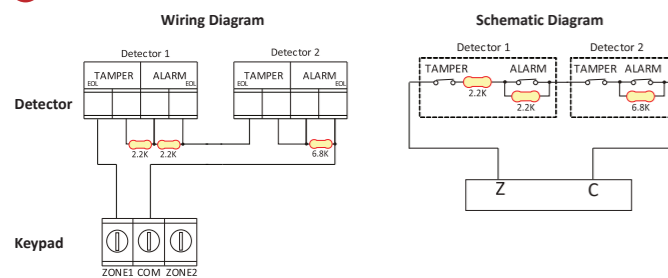

Step 4. Install on the wall.

1) Use 4 screws (KA4X25) to fix the back cover to the wall, then connect and organize the cables.

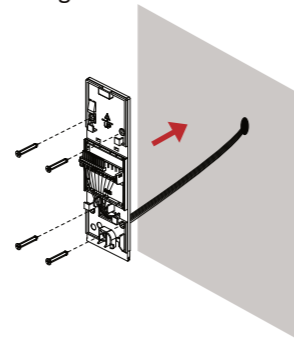

Note: You can also knock out the indicated area for cable wiring.

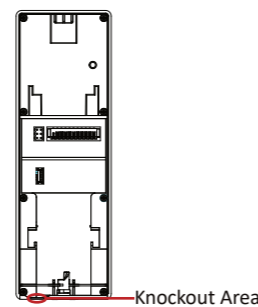

2) Hang the device onto the back cover from top to bottom until a click is heard.

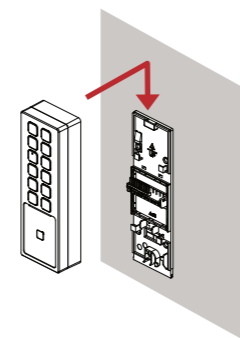

B Configuration on Device

You can arm/disarm or send alarm notification via the keypad. Follow the tables to perform the actions.

| Action | Function | Operation |
|--|---|--|
| Arm/Disarm | If the control panel set the authorization type as Keypad PIN Only : You can arm/disarm all areas under the associated user. | 【PIN】 + 【#】 |
| | If the control panel set the authorization type as Keypad PIN Only : You can arm/disarm the specified area under the user. (only one area at a time) | 【PIN】 + 【*】 + 【Area No.】 + 【#】 |
| | If the control panel set the authorization type as Tag Only : You can arm all areas under the user. | 【Present Tag for a Long Time】 |
| | If the control panel set the authorization type as Tag Only : You can disarm all areas under the user. | 【Present Tag for a short Time】 |
| | If the control panel set the authorization type as Tag or Keypad PIN : You can perform the operations above under the user. | All four of the above operations are valid. |
| Duress Alarm | If the control panel set the authorization type as Tag and Keypad PIN : You can arm all areas under the user. | 【PIN】 + 【#】 + 【Long Present】 Or 【Long Present】 + 【PIN】 + 【#】 |
| | If the control panel set the authorization type as Tag and Keypad PIN : You can disarm all areas under the user. | 【PIN】 + 【#】 + 【Short Present】 Or 【Short Present】 + 【PIN】 + 【#】 |
| Replace the 【PIN】 in the above operations with 【Duress Code】 | | |
| Confirm Arming | Trigger a duress alarm. | 【#】 |
| Confirm Arming | Confirm arming during the arming process | 【#】 |
| Clear Input | Clear entered keys for re-entry | 【Hold *】 |

About this Document

- This Document includes instructions for using and managing the Product. Pictures, charts, images and all other information hereinafter are for description and explanation only.
- The information contained in the Document is subject to change, without notice, due to firmware updates or other reasons. Please find the latest version of the Document at the Hikvision website (<https://www.hikvision.com>). Unless otherwise agreed, Hangzhou Hikvision Digital Technology Co., Ltd. or its affiliates (hereinafter referred to as "Hikvision") makes no warranties, express or implied.
- Please use the Document with the guidance and assistance of professionals trained in supporting the Product.

About this Product

This product can only enjoy the after-sales service support in the country or region where the purchase is made.

Acknowledgment of Intellectual Property Rights

- Hikvision owns the copyrights and/or patents related to the technology embodied in the Products described in this Document, which may include licenses obtained from third parties.
- Any part of the Document, including text, pictures, graphics, etc., belongs to Hikvision. No part of this Document may be excerpted, copied, translated, or modified in whole or in part by any means without written permission.
- HIKVISION and other Hikvision's trademarks and logos are the properties of Hikvision in various jurisdictions.
- Other trademarks and logos mentioned are the properties of their respective owners.

LEGAL DISCLAIMER

TO THE MAXIMUM EXTENT PERMITTED BY APPLICABLE LAW, THIS DOCUMENT AND THE PRODUCT DESCRIBED, WITH ITS HARDWARE, SOFTWARE AND FIRMWARE, ARE PROVIDED "AS IS" AND "WITH ALL FAULTS AND ERRORS". HIKVISION MAKES NO WARRANTIES, EXPRESS OR IMPLIED, INCLUDING WITHOUT LIMITATION, MERCHANTABILITY, SATISFACTORY QUALITY, OR FITNESS FOR A PARTICULAR PURPOSE. THE USE OF THE PRODUCT BY YOU IS AT YOUR OWN RISK. IN NO EVENT WILL HIKVISION BE LIABLE TO YOU FOR ANY SPECIAL, CONSEQUENTIAL, INCIDENTAL, OR INDIRECT DAMAGES, INCLUDING, AMONG OTHERS, DAMAGES FOR LOSS OF BUSINESS PROFITS, BUSINESS INTERRUPTION, OR LOSS OF DATA, CORRUPTION OF SYSTEMS, OR LOSS OF DOCUMENTATION, WHETHER BASED ON BREACH OF CONTRACT, TORT (INCLUDING NEGLIGENCE), PRODUCT LIABILITY, OR OTHERWISE, IN CONNECTION WITH THE USE OF THE PRODUCT, EVEN IF HIKVISION HAS BEEN ADVISED OF THE POSSIBILITY OF SUCH DAMAGES OR LOSS.

YOU ACKNOWLEDGE THAT THE NATURE OF THE INTERNET PROVIDES FOR INHERENT SECURITY RISKS, AND HIKVISION SHALL NOT TAKE ANY RESPONSIBILITIES FOR ABNORMAL OPERATION, PRIVACY LEAKAGE OR OTHER DAMAGES RESULTING FROM CYBER-ATTACK, HACKER ATTACK, VIRUS INFECTION, OR OTHER INTERNET SECURITY RISKS; HOWEVER, HIKVISION WILL PROVIDE TIMELY TECHNICAL SUPPORT IF REQUIRED.

YOU AGREE TO USE THIS PRODUCT IN COMPLIANCE WITH ALL APPLICABLE LAWS, AND YOU ARE SOLELY RESPONSIBLE FOR ENSURING THAT YOUR USE CONFORMS TO THE APPLICABLE LAW. ESPECIALLY, YOU ARE RESPONSIBLE, FOR USING THIS PRODUCT IN A MANNER THAT DOES NOT INFRINGE ON THE RIGHTS OF THIRD PARTIES, INCLUDING WITHOUT LIMITATION, RIGHTS OF PUBLICITY, INTELLECTUAL PROPERTY RIGHTS, OR DATA PROTECTION AND OTHER PRIVACY RIGHTS. YOU SHALL NOT USE THIS PRODUCT FOR ANY PROHIBITED END-USES, INCLUDING THE DEVELOPMENT OR PRODUCTION OF WEAPONS OF MASS DESTRUCTION, THE DEVELOPMENT OR PRODUCTION OF CHEMICAL OR BIOLOGICAL WEAPONS, ANY ACTIVITIES IN THE CONTEXT RELATED TO ANY NUCLEAR EXPLOSIVE OR UNSAFE NUCLEAR FUEL-CYCLE, OR IN SUPPORT OF HUMAN RIGHTS ABUSES.

IN THE EVENT OF ANY CONFLICTS BETWEEN THIS DOCUMENT AND THE APPLICABLE LAW, THE LATTER PREVAILS.

© Hangzhou Hikvision Digital Technology Co., Ltd. All rights reserved.

B When Detector Contact Mode is NO

1 Non Resistor Wiring

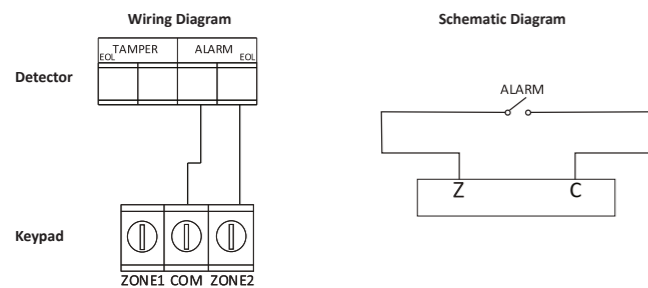

2 Single EOL Wiring

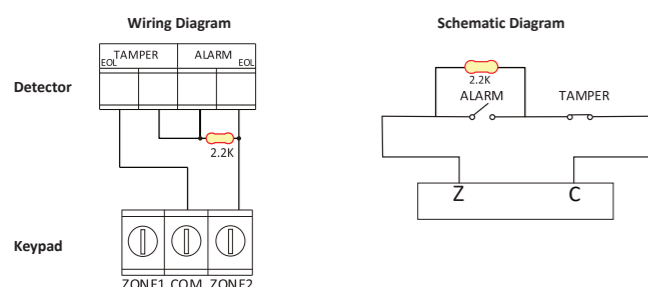

3 Quick Configuration

A Configuration on App

After the peripherals are wired with BUS, they are enrolled on the control panel automatically. You can configure the peripherals' parameters on the App.

Step 1. Scan the QR code to download the mobile App.



Step 2. Tap the device on the device list page, and tap to configure device parameters. For detailed configuration, see the user manual.